

PATA 116 (Old PATA 11e)
Road Closure With Detour

PATA 116 (Old PATA 11e) - Notes

1. This figure applies for stationary operations where it is not feasible to maintain alternate one direction traffic flow.
2. This setup is to be used during daylight hours only and only on roadways with an ADT of 1500 or less. The PATA may be approved by the District Traffic Engineer for use on other roads.
3. Hours of work should not interfere with rush hour (6:00-9:00 AM and 3:00-6:00 PM) or school bus schedules and the work site must be capable of accommodating emergency vehicles with as little delay as possible.
4. At locations where there are overlapping detours or several detours within the same area, street names may be added to the M4-9 series signs, or signs with different colored arrows may be used to designate different detour routes. The design and application of signs displaying colored arrows shall comply with PennDOT Publication 236.
5. The Road Closed-Local Traffic Only (R11-3A) sign may be used in place of the Road Closed To Thru Traffic (R11-4) sign.
6. This Street To Be Closed For Maintenance Next Week (W23-101) signs should be installed for scheduled work. Install the signs at most appropriate locations.

Signs

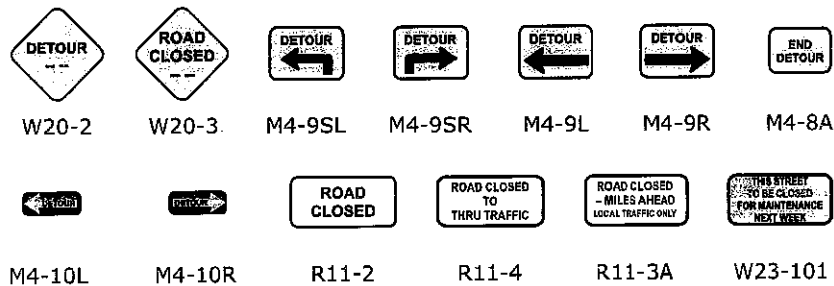

Sign Spacing Chart

Condition	Distance			
	A	B	C	F
	Feet	Feet	Feet	Feet
Urban 35 MPH or less	100	100	100	100
Urban Greater than 35 MPH	350	350	350	350
Rural	500	500	500	500

When multiple distance plaques are used on advance warning signs, they shall all be of the same series type.
 Example: either all "AHEAD" or XXX FEET.

Taper Length Formulas

S	L
40 MPH or less	$L = \frac{WS^2}{60}$
45 MPH or more	$L = WS$

S = Regulatory Speed Limit
 W = Width of Offset
 L = Length

Distance and Spacing Quick Reference Chart

Speed MPH	W	L	1/2L	1/3L	Min. Channelizing Devices Per Taper Type (Length)				D	E	H
	Feet	Feet	Feet	Feet	L	1/2L	1/3L	50'	Feet	Feet	Feet
25	10	105	55	35	6	6	6	6	50	155	150
	11	115	60	40							
	12	125	65	45							
30	10	150	75	50	6	6	6	6	60	200	150
	11	165	85	55							
	12	180	90	60							
35	10	205	105	70	6	6	6	6	70	250	150
	11	225	115	75							
	12	245	125	85							
40	10	270	135	90	6	6	6	6	80	305	150
	11	295	150	100							
	12	320	160	110							
45	10	450	225	150	6	6	6	6	90	360	150
	11	495	250	165							
	12	540	270	180							
50	10	500	250	170	6	6	6	6	100	425	250
	11	550	275	185							
	12	600	300	200							
55	10	550	275	185	6	6	6	6	110	495	250
	11	605	305	205							
	12	660	330	220							

Note: Channelizing devices used in taper shall be equally spaced at 1/2 D Max.